

LET'S GET CONNECTED.

Welcome to pi-top [4], your programmable computing device that combines digital making and coding with amazing real-world projects.

Firstly, let's take a look at the [Display Cable](#)...

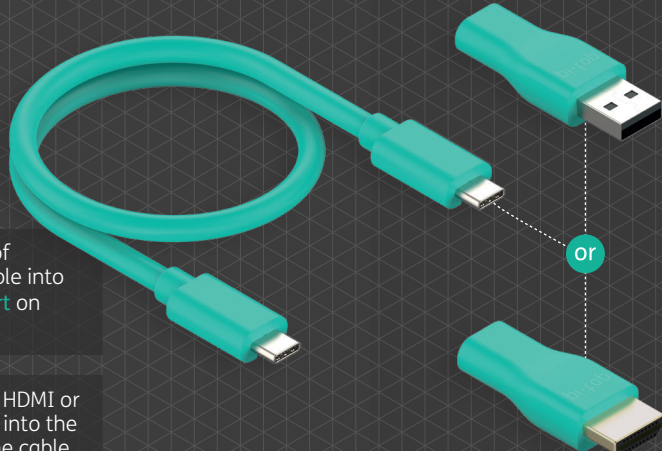

1 Plug one side of the Display Cable into the [Display port](#) on the pi-top [4].

2 Plug either the HDMI or USB-A adapter into the other end of the cable.

The pi-top [4] comes with the USB-A adapter already attached.



There is a small amount of charge in your pi-top [4] battery, but please plug in the power supply to fully charge it before you begin!

Option A

USB-A adapter
For connecting to a computer.

Option B

HDMI adapter
For connecting to a monitor or TV.

Option A Connecting to a computer

1 REALVNC

Install and launch VNC on your computer. This is a third-party screen sharing software. You can download it for free here:

www.realvnc.com/en/connect/download/viewer/

2 Plug the Display Cable into pi-top [4] and your computer via the USB-A adapter.

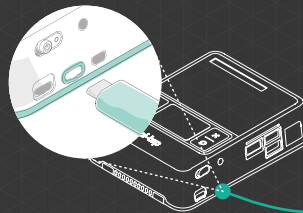

3 Power up the pi-top [4] and enter this IP address into the VNC viewer:

192.168.64.1

You will then need to enter these details to login:

Username: **pi**
Password: **pi-top**

! If your computer only has USB-C ports, you'll need a USB-A dongle to connect.

GET MAKING!

Option B Connecting to a monitor or TV

1 Plug the Display Cable into the pi-top [4] and your monitor via the HDMI adapter.

2 Plug in your mouse and keyboard via USB.

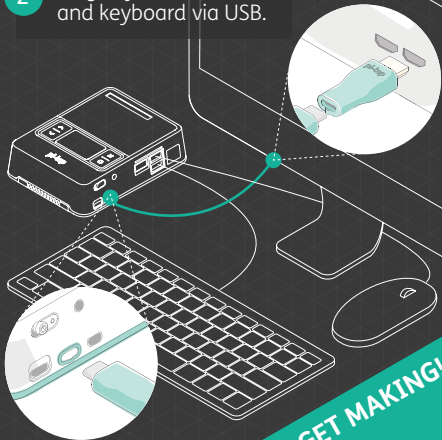

GET MAKING!

WHAT'S IN THE BOX?

- pi-top [4]
- *Containing the Raspberry Pi 4*
- 16GB SD card with pi-topOS
- Power supply
- pi-top Display Cable
- HDMI Adapter
- USB Adapter

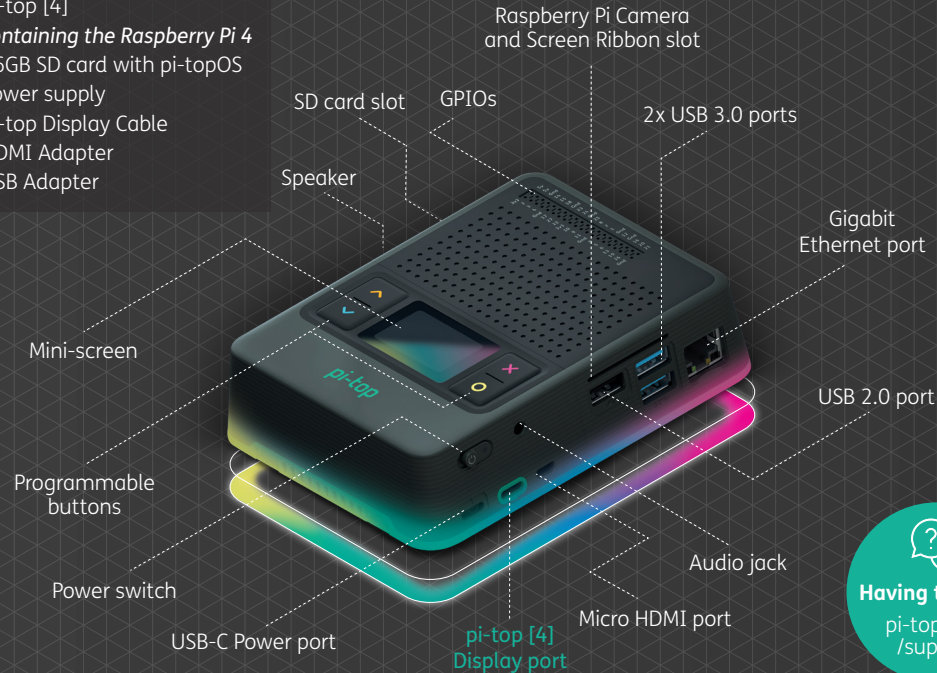

Having trouble?
pi-top.com/support

[4]